

# THE PROPOSED MIXED-USE DEVELOPMENT ON ERF 2187, THREE ANCHOR BAY

## TRANSPORT IMPACT ASSESSMENT

### BASEMENT PARKING & ACCESS

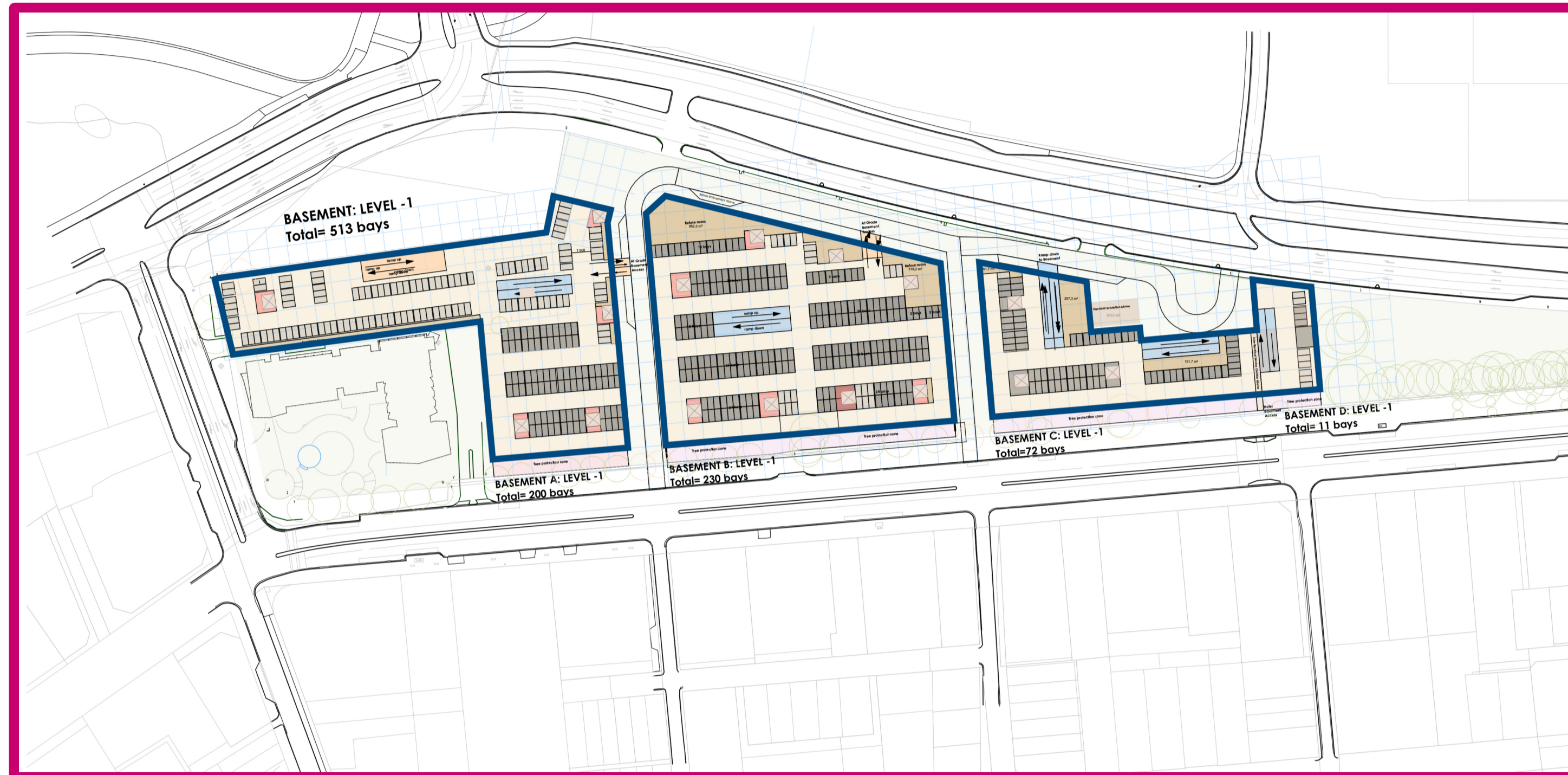

**Basement Parking Level 1**

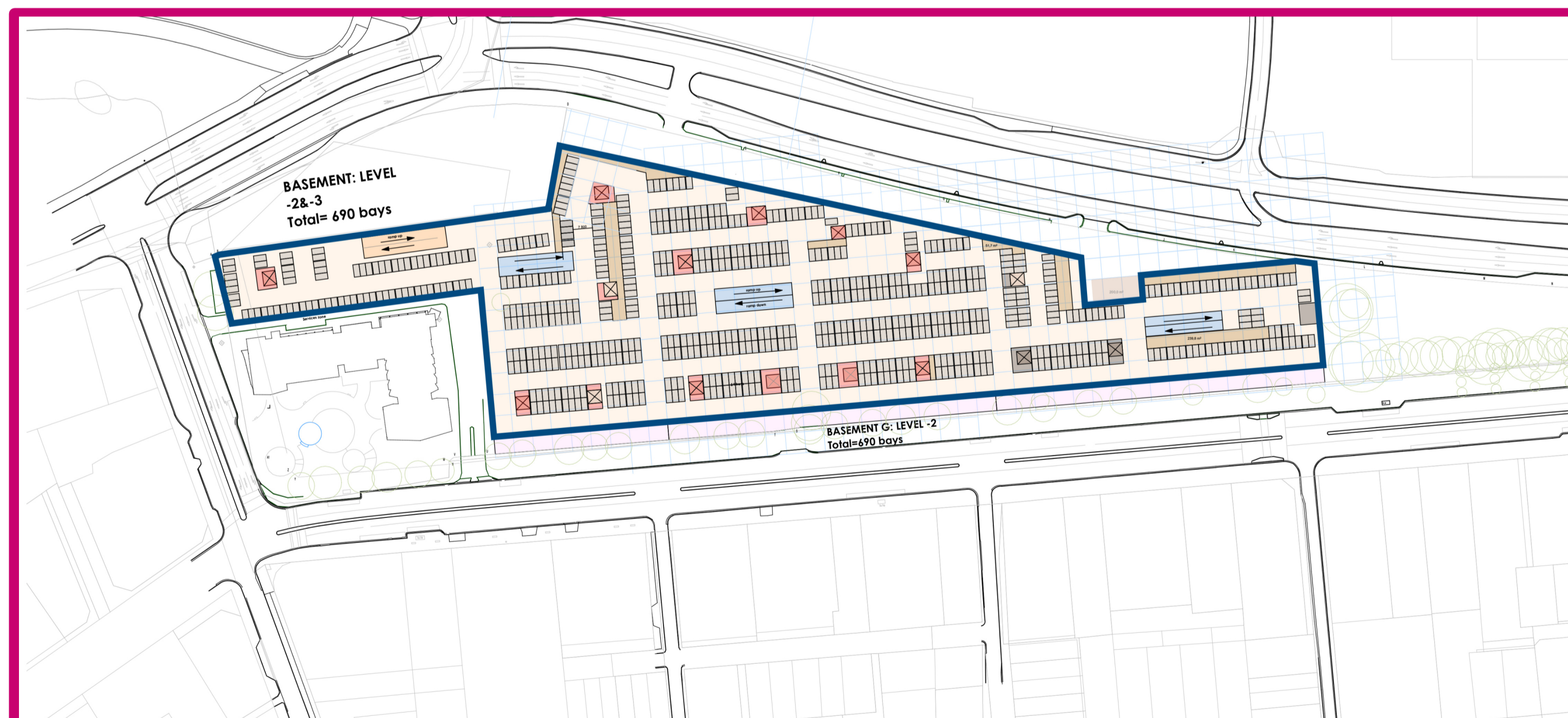

**Basement Parking Level 2 & 3**



#### NORTH ACCESS

Basement access is primarily located along the northern edge for convenient at-grade entry



#### THREE BASEMENT LEVELS

Structured parking is provided across three basement levels

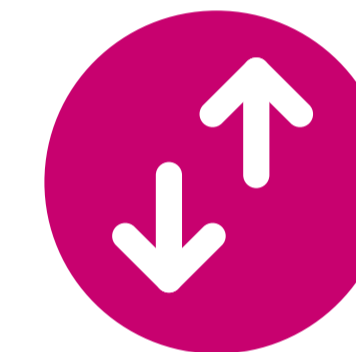

#### SUPER BASEMENT

Basement Levels -2 and -3 are arranged as a super-basement.

Although the site falls within a PT2 zone where no minimum parking requirements apply, PT1 parking ratios are proposed in the concept design.

The below table is indicative of the number of bays that could be accommodated within the concept design (ratios may change at development stage)

Basement Level	No. of Parking Bays
Basement Level 1	Approximately 513 parking bays
Basement Level 2 & 3	Approximately 690 parking bays (per level)
Additional Parking	Approximately 80 parking bays
<b>Total</b>	<b>Approximately 1975</b>